

# OPERATING INSTRUCTIONS

## BIO ETHANOL FIREPLACES

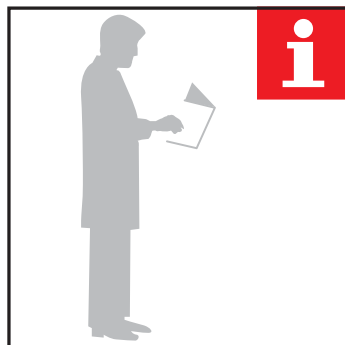

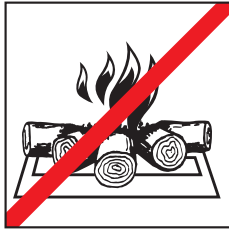

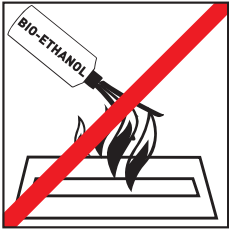
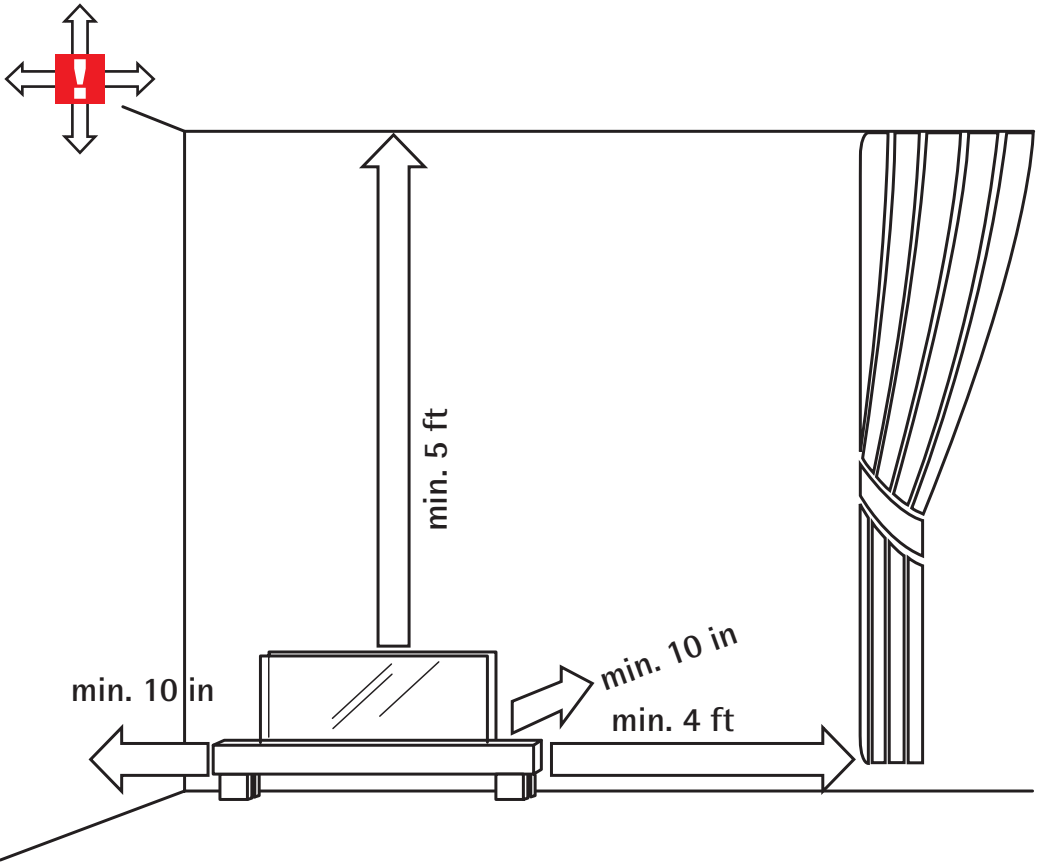

**!** max. 1.5 liters

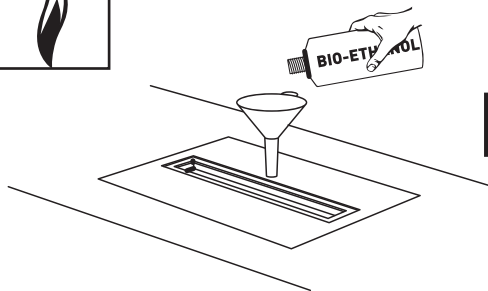

**5 min.**

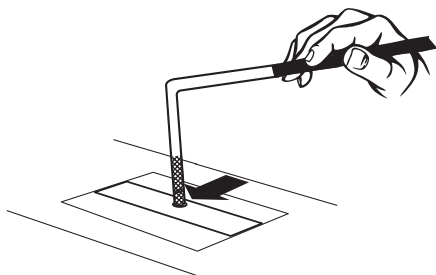
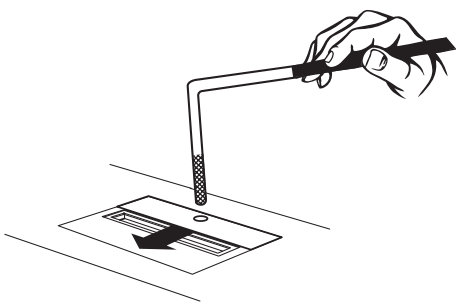
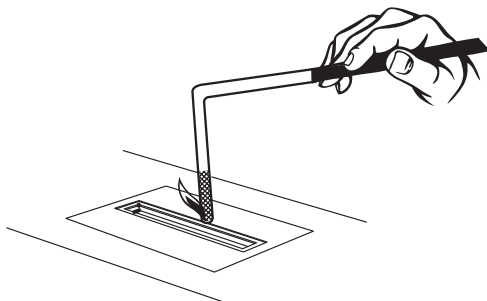
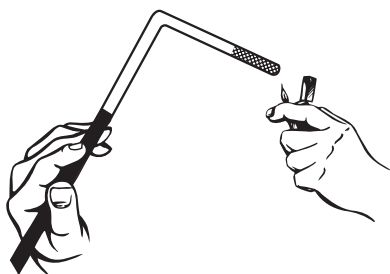
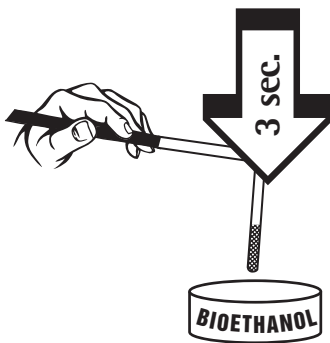



## Important information!

Never use your fireplace if it has been damaged or modified in any way.

Improper use or failure to follow appropriate safety precautions may result in serious injury or death as well as damage to or loss of property.

Read all information completely before using your Buschbeck bio ethanol fireplace. Do not discard these instructions. Keep them with your Buschbeck bio ethanol fireplace for future reference.

### Choose a proper location for your fireplace!

Place your Buschbeck bio ethanol fireplace on a solid, flat, level foundation where it will not be accidentally kicked or bumped by any unsuspecting person or animal.

Place it safely away (4 feet or more) from any potentially flammable objects. Moveable objects (curtains, drapes, etc.) must not be allowed to come within 4 feet of the fireplace, and never above it.

Keep the fireplace away from drafts or any type of wind such as from fans, ventilators, etc.

Position the fireplace at least 10 inches away from any wall or vertical surface and at least 5 feet from any ceiling or overhanging objects.

## Read carefully before using!

Never allow children or animals near the fireplace. Never allow the fireplace to burn without adult supervision.

The fireplace may become very hot during use. Do not touch any surface without allowing proper time to cool. Use the lighting and flame adjustment tool (supplied) to slide the flat stainless steel insert over the firebox to extinguish or to adjust the flame. The flat stainless steel insert must be placed on top of the firebox during use. See the drawings supplied with the fireplace for proper orientation of parts.

Never bend over the fireplace when lighting the flame. Do not allow face, hands or other body parts or clothing to extend over the fireplace.

Do not store additional fuel anywhere near the fireplace. Fuel is designed to burn and fumes can be explosive.

Exercise extreme caution and follow all instructions carefully.

Keep additional fuel tightly capped and away from any potential source of combustion.

## Fuel

Your Buschbeck bio ethanol fireplace is designed to be used only with the highest quality pure bio ethanol fuel such as OZOfire™ brand ([www.FuelBarons.com](http://www.FuelBarons.com)), available from your fireplace retailer.

The highest quality bio ethanol fuel should not produce any harmful pollutants. Always refer to the information provided by the supplier of the fuel. Study all information available from the fuel supplier. Follow all instructions and recommendations from the fuel supplier exactly.

Buschbeck bio ethanol fireplaces have been designed and manufactured to the highest quality and safety standards. Buschbeck bio ethanol fireplaces have been tested and certified by government agencies and independent laboratories – and have received the highest ratings for quality and safety. You will only realize the benefits of this quality design and safety when the best and purest bio ethanol fuel is used.

The Buschbeck firebox chamber is designed to hold up to 1.5 liters of fuel. Use the handy funnel (supplied) to fill the fuel chamber. Do not over fill. Clean and dry any spills and wait 5 minutes before lighting the flame. Never add fuel when the firebox is warm or when there is any flame present. Allow the firebox to cool for at least 15 minutes before refilling.



## Important information! Read carefully before using!

While your Buschbeck bio ethanol fireplace is designed and approved for indoor use, careful consideration should be given to the following issues –

Proper air exchange is absolutely necessary to maintaining adequate oxygen levels for breathing. Any flame consumes oxygen. The oxygen that is consumed must be replaced in order to maintain an atmosphere that is healthy for breathing. This usually occurs automatically through the normal air exchange that takes place through walls, cracks and seams in the building. If there is any doubt, additional fresh air should be introduced by way of an open window, while the fire is burning.

The size of the room is one of the most important matters to consider.

**DO NOT OPERATE THE FIREPLACE IN SMALL OR TIGHTLY ENCLOSED SPACES.**

The information on page 7 may be helpful in determining air exchange requirements.

---

### SAFETY INSTRUCTIONS FOR HANDLING BIO-ETHANOL

F



UN 1170 Ethanol, solution > 95% vol. – completely methylated with 1% methyl ethyl ketone and 10 ppm denatonium benzoate ADR: 3,II / Water Hazard Classification: 1

**Keep out of the reach of children! Never pour into open flame or embers!**

**Not suitable for human consumption! Keep container sealed and closed!**

**Keep away from ignition sources!**

Xi



**If swallowed, immediately call a physician and show the packing/label!**

**Protect from strong sunlight!**

**Immediately wipe up spilled ethanol with a moist cloth!**



# Important information!

## Read carefully before using!

### TECHNICAL DATA

Filling volume, ethanol	1.5 liters
Combustion time	ca. 3-5 - 4 hours
Fuel throughput	0.44 l (max. 0.5 liter permitted)

### INSTALLATION CONDITIONS

Minimum room volume cubic meters	Air exchange [1/h]
332	0,2 (1)
111	0,6 (2)
66	1,0 (3)

- (1) Air exchange rate due to leakage in the building
- (2) Normal air exchange rate in leakproof buildings with standard
- (3) Complete air exchange in installation room during one hour

Air exchange [n/h]*	Comments
0 ... 0,5	Windows, doors closed
0,3 ... 1,5	Window open, no shutters
5 ... 10	Window half open

user airing habits

- \* n/h refers to the ratio of air circulation in the room. For example, 0.5/h means that half of the air in the room is replaced each hour.

### USE ONLY GENUINE REPLACEMENT PARTS!

(Firebox; Single-pane safety glass)

TÜV certified



Prüfbericht-Nr.  
W-O 1173-00/08

The fire safety and operational safety of the device have been tested by TÜV Süd Industrie Service, Munich.

(Test report no. W-O 1173-00/08).

Buschbeck GmbH  
Friedrich-Engels-Straße 21  
D-51545 Waldbröl  
Germany

[www.buschbeck-indoor.de](http://www.buschbeck-indoor.de)

**buschbeck**

MADE IN EU

